

# UNIT A9

FLOORS 11-31  
1 BEDROOM / 1 STUDY / 1.5 BATHROOM

INTERIOR 1,036 SF  
BALCONY 46 SF  
**TOTAL 1,082 SF**

## UNIT FEATURES

- Fully furnished
- Modern, open concept
- Smooth-finished 10' ceilings
- Floor-to-ceiling glass doors and windows
- European style kitchen cabinets with contemporary hardware
- Premium European style plumbing fixtures

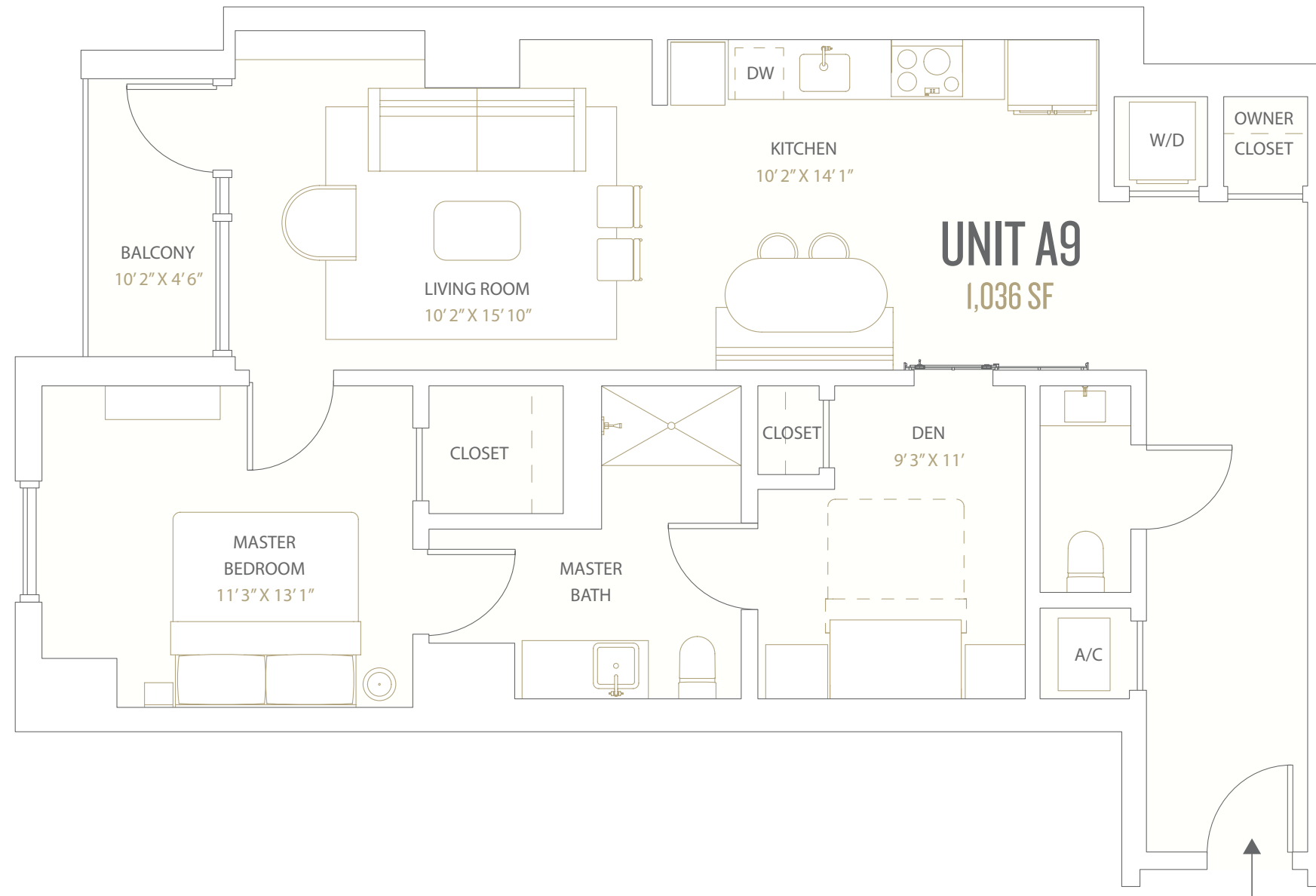

48 East Avenue  
Austin, TX 78701

[natiivoaustin.com](http://natiivoaustin.com) | 888.267.6353



Floor plans are not to scale, dimensions are approximate, and may vary from the description of the unit in the condominium declaration. Materials are based on a photographic representation and are illustrative. You should review the actual materials at the sales office prior to making your finish selections. Furnishings shown are for representation purposes only. Certain images are based on photos or digital representations and have been artistically assembled and/or retouched. Views may change based on development or other factors. This condominium is being developed by 48 East Property, LLC ("Developer"), which has a limited right to use the trademarked names and logos of Natiivo pursuant to a license and marketing agreement. Any and all statements, disclosures and/or representations shall be deemed made by Developer and not by Natiivo and you agree to look solely to Developer (and not to Natiivo and/or any of its or their affiliates) with respect to any and all matters relating to the marketing and/or development of the Condominium and with respect to the sales of units in the Condominium. We are in compliance with Title VIII of the Civil Rights Act of 1968. We have not, and will not, either directly or indirectly, discriminate against you or any other prospective purchaser on the basis of race, color, religion, sex or national origin. Price and availability subject to change. Renderings, photos, and © 2019. NGD Homesharing LLC and 48 East Property, LLC. All rights reserved.

LADY BIRD LAKE &  
HIKE AND BIKE TRAIL

EAST AVENUE

↑  
NORTH